

TEES UGUALI

ASME B16.9 ASTM A 403
WP 304/304L E WP 316/316L

EQUAL TEES

ASME B16.9 ASTM A 403
WP 304/304L AND WP 316/316L

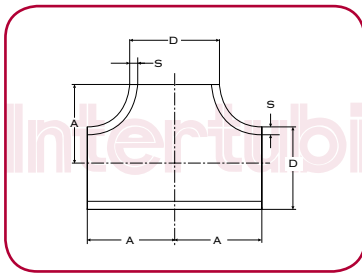

Ø est. mm x Sp. mm Outs. Ø mm x Thck. mm	Dimensioni Dimensions	Peso Kg/pz. Weight Kg/pcs.	A
21.34 x 2.11	1/2" SCH 10S	0.07	25
21.34 x 2.77	1/2" SCH 40S	0.08	25
21.34 x 3.73	1/2" SCH 80S	0.14	25
21.34 x 4.75	1/2" SCH 160	0.15	25
26.67 x 2.11	3/4" SCH 10S	0.09	29
26.67 x 2.87	3/4" SCH 40S	0.11	29
26.67 x 3.91	3/4" SCH 80S	0.20	29
26.67 x 5.54	3/4" SCH 160	0.30	29
33.40 x 2.77	1" SCH 10S	0.20	38
33.40 x 3.38	1" SCH 40S	0.24	38
33.40 x 4.55	1" SCH 80S	0.39	38
33.40 x 6.35	1" SCH 160	0.47	38
42.16 x 2.77	1.1/4" SCH 10S	0.33	48
42.16 x 3.56	1.1/4" SCH 40S	0.41	48
42.16 x 4.85	1.1/4" SCH 80S	0.54	48
42.16 x 6.35	1.1/4" SCH 160	0.89	48
48.26 x 2.77	1.1/2" SCH 10S	0.46	57
48.26 x 3.68	1.1/2" SCH 40S	0.60	57
48.26 x 5.08	1.1/2" SCH 80S	1.02	57
48.26 x 7.14	1.1/2" SCH 160	1.43	57
60.33 x 2.77	2" SCH 10S	0.63	64
60.33 x 3.91	2" SCH 40S	0.87	64
60.33 x 5.54	2" SCH 80S	1.60	64
60.33 x 8.71	2" SCH 160	3.18	64
73.03 x 3.05	2.1/2" SCH 10S	1.10	76
73.03 x 5.16	2.1/2" SCH 40S	1.70	76
73.03 x 7.01	2.1/2" SCH 80S	3.63	76
88.90 x 3.05	3" SCH 10S	1.37	86

Ø est. mm x Sp. mm Outs. Ø mm x Thck. mm	Dimensioni Dimensions	Peso Kg/pz. Weight Kg/pcs.	A
88.90 x 5.49	3" SCH 40S	1.90	86
88.90 x 7.62	3" SCH 80S	4.45	86
88.90 x 11.13	3" SCH 160	5.87	86
101.6 x 3.05	31/2" SCH 10S	1.74	95
101.6 x 5.74	31/2" SCH 40S	3.19	95
114.30 x 3.05	4" SCH 10S	2.15	105
114.30 x 6.02	4" SCH 40S	4.13	105
114.30 x 8.56	4" SCH 80S	7.70	105
114.30 x 13.49	4" SCH 160	9.76	105
141.30 x 3.40	5" SCH 10S	3.48	124
141.30 x 6.55	5" SCH 40S	6.55	124
168.28 x 3.40	6" SCH 10S	4.76	143
168.28 x 7.11	6" SCH 40S	9.73	143
168.28 x 10.97	6" SCH 80S	13.61	143
219.08 x 3.76	8" SCH 10S	8.46	178
219.08 x 8.18	8" SCH 40S	18.00	178
219.08 x 12.70	8" SCH 80S	27.40	178
273.05 x 4.19	10" SCH 10S	14.20	216
273.05 x 9.27	10" SCH 40S	30.60	216
323.85 x 4.57	12" SCH 10S	21.60	254
323.85 x 9.53	12" SCH 40S	44.30	254
355.60 x 4.78	14" SCH 10S	48.53	279
355.60 x 9.53	14" SCH 40S	79.38	279
406.40 x 4.77	16" SCH 10S	58.90	305
406.40 x 9.53	16" SCH 40S	99.70	305

Nota: i dati tecnici su questo catalogo sono indicativi e non impegnativi / Note: the technical data reported in this catalogue is proximate and not binding.
Data di emissione: 2014 Revisione: 01 / Date of issue: 2014 Revision: 01

Copyright © Intertubi S.p.a. Tutti i diritti sono riservati / Copyright © Intertubi S.p.a. All rights reserved