

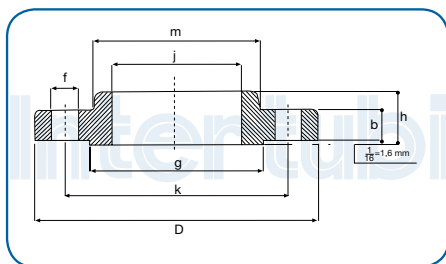

Intertubi



150 LBS

Nom. Size	D	b	g	m	j	h	k	Fori Holes	f	Kg
	mm	mm	mm	mm	mm	mm	mm		mm	
1/2"	90	11.2	34.9	30	22.2	14	60.3	4	15.9	0.40
3/4"	100	12.7	42.9	38	27.7	14	69.9	4	15.9	0.70
1"	110	14.3	50.8	44	34.5	16	79.4	4	15.9	0.80
1 1/4"	115	15.9	63.5	59	43.2	19	88.9	4	15.9	1.10
1 1/2"	125	17.5	73.0	65	49.5	21	98.4	4	15.9	1.40
2"	150	19.1	92.1	78	61.9	24	120.7	4	19.0	2.20
2 1/2"	180	22.3	104.8	90	74.7	27	139.7	4	19.0	3.60
3"	190	23.9	127.0	108	90.7	29	152.4	4	19.0	4.10
3 1/2"	215	23.9	139.7	122	103.4	30	177.8	8	19.0	5.20
4"	230	23.9	157.2	135	116.1	32	190.5	8	19.0	5.60
5"	255	23.9	185.7	164	143.8	35	215.9	8	22.2	6.30
6"	280	25.4	215.9	192	170.7	38	241.3	8	22.2	7.50
8"	345	28.6	269.9	246	221.5	43	298.4	8	22.2	12.60
10"	405	30.2	323.8	305	276.3	48	361	12	25.4	18.50
12"	485	31.8	381.0	365	327.1	54	431.8	12	25.4	28.00
14"	535	35.0	412.7	400	359.1	56	476.2	12	28.6	36.00
16"	595	36.6	469.9	457	410.5	62	539.8	16	28.6	46.00
18"	635	39.7	533.4	505	461.8	67	577.9	16	31.7	50.00
20"	700	42.9	584.2	559	513.1	71	635.0	20	31.7	64.00
24"	815	47.7	692.1	663	616.0	81	749.3	20	34.9	89.00

FLANGE SLIP-ON FORGIATE

ASME B 16.5
ASTMA 182
ASTMA 105
ASTMA 403
150 / 300 / 600 LBS

FORGED SLIP-ON FLANGES

ASME B 16.5
ASTMA 182
ASTMA 105
ASTMA 403
150 / 300 / 600 LBS

STAINLESS STEEL AND CARBON STEEL

300 LBS

Nom. Size	D	b	g	m	j	h	k	Fori Holes	f	Kg
	mm	mm	mm	mm	mm	mm	mm		mm	
1/2"	95	14.3	34.9	38	22.2	21	66.7	4	15.9	0.70
3/4"	115	15.9	42.9	48	27.7	24	82.6	4	19.0	1.10
1"	125	17.5	50.8	54	34.5	25	88.9	4	19.0	1.40
1 1/4"	135	19.1	63.5	64	43.2	25	98.4	4	19.0	1.80
1 1/2"	155	20.6	73.0	70	49.5	29	114.3	4	22.2	2.60
2"	165	22.2	92.1	84	61.9	32	127.0	8	19.0	3.40
2 1/2"	190	25.4	104.8	100	74.7	37	149.2	8	22.2	4.40
3"	210	28.6	127.0	117	90.7	41	168.3	8	22.2	6.10
3 1/2"	230	30.2	139.7	133	103.4	43	184.2	8	22.2	7.50
4"	255	31.7	157.2	146	116.1	46	200.0	8	22.2	10.10
5"	280	34.9	185.7	178	143.8	49	235.0	8	22.2	12.50
6"	320	36.5	215.9	206	170.7	51	269.9	12	22.2	14.10
8"	380	41.3	269.9	260	221.5	60	330.2	12	25.4	24.80
10"	445	47.6	323.8	321	276.3	65	387.4	16	28.6	37.10
12"	520	50.8	381.0	375	327.1	71	450.8	16	31.7	50.00

600 LBS

Nom. Size	D	b	g	m	j	h	k	Fori Holes	f	Kg
	mm	mm	mm	mm	mm	mm	mm		mm	
1/2"	95	14.3	34.9	38	22.2	22	66.7	4	15.9	0.80
3/4"	115	15.9	42.9	48	27.7	25	82.6	4	19.0	1.40
1"	125	17.5	50.8	54	34.5	27	88.9	4	19.0	1.60
1 1/4"	135	20.7	63.5	64	43.2	29	98.4	4	19.0	2.10
1 1/2"	155	22.3	73.0	70	49.5	32	114.3	4	22.2	3.10
2"	165	25.4	92.1	84	61.9	37	127.0	8	19.0	3.70
2 1/2"	190	28.6	104.8	100	74.7	41	149.2	8	22.2	5.40
3"	210	31.8	127.0	117	90.7	46	168.3	8	22.2	7.30
4"	275	38.1	157.2	152	116.1	54	200.0	8	25.4	11.8
5"	330	44.5	185.7	189	143.8	60	235.0	8	28.6	24.5
6"	355	47.7	215.9	222	170.7	67	269.9	12	28.6	29.5
8"	420	55.6	269.9	273	221.5	76	330.2	12	31.7	43.0
10"	510	63.5	323.8	343	276.3	86	387.4	16	34.9	70.0
12"	560	66.7	381.0	400	327.1	92	450.8	20	34.9	86.0